



£267,995

Lilystreet Farm Way, Alfreton DE55 1FJ

Semi-Detached House | 3 Bedrooms | 2 Bathrooms

01773 832355

DERBYSHIRE  
PROPERTIES  
SALES & LETTINGS

[www.derbyshireproperties.com](http://www.derbyshireproperties.com)



# Step Inside

---

## Key Features

- Three Bedroomed Semi Detached house
- En-Suite to Master Bedroom
- Open Plan Lounge / Diner
- Close to Local Amenities
- Viewing Highly Recommended

## Property Description

The Worthington is an impressive three bedroomed semi detached home.

## Main Particulars

The Worthington is a modern three-bedroom home in Alfreton which features an open-plan lounge and dining space, front-facing kitchen, and downstairs WC. First Floor, three bedrooms with en-suite to master and family Bathroom.

### Information

Nestled within the beautiful rural region of Derbyshire, and between the historic towns of Ripley and Alfreton, Lily Street Farm features a collection of charming, sought-after homes, well suited for commuters. Its close proximity to the A38 provides convenient access to cities such as Derby, Nottingham and Chesterfield, providing a cultural break where purchasers can benefit from an abundance of shops, restaurants and attractions.

The picturesque village of Swanwick is a great base to explore the nearby Peak District delights, while affording commuters with access to major cities. The location offers a welcoming home to unwind in the scenic Amber Valley countryside.

Close by is the East Midlands Designer Outlet, with more than 65 stores, it is renowned in the Midlands as the leading designer outlet where shoppers can enjoy a wonderful day out with the entire family. For history buffs, Heage Windmill is a must-visit attraction as the 18th Century structure is the only surviving six-sailed, stone-built windmill in Britain. Visitors can purchase freshly stone-milled flour from its onsite shop, after exploring the historical structure.

Only a short drive away, Crich Tramway Village transports visitors back in time as they wander along a period street, complete with pub and sweet shop selling traditional treats from a bygone age. Many of the buildings along the street have been rescued from towns and cities across the UK - lovingly recreated, brick by brick to give a genuine sense of nostalgia.

### Info

\*Choice where stage of construction permits please check with our Sales Executive Peveril Homes subscribes to the Consumer Code of Conduct. Please refer to the Sales Executives for details. Please note Peveril Homes operate a policy of continuous development and improvement and reserves the right to alter or amend the specification at any time without notice. Please check specific plot details with the Sales Executive prior to commitment, particularly on items that are important to you. Part Exchange is subject to Peveril Homes Terms & Conditions. Images show typical Peveril Homes interiors \*T&C apply, single residency stamp duty only. Contact our Sales Executives for qualifying plots. Not to be used in conjunction with any other scheme or offer. Offer may be withdrawn without notice.



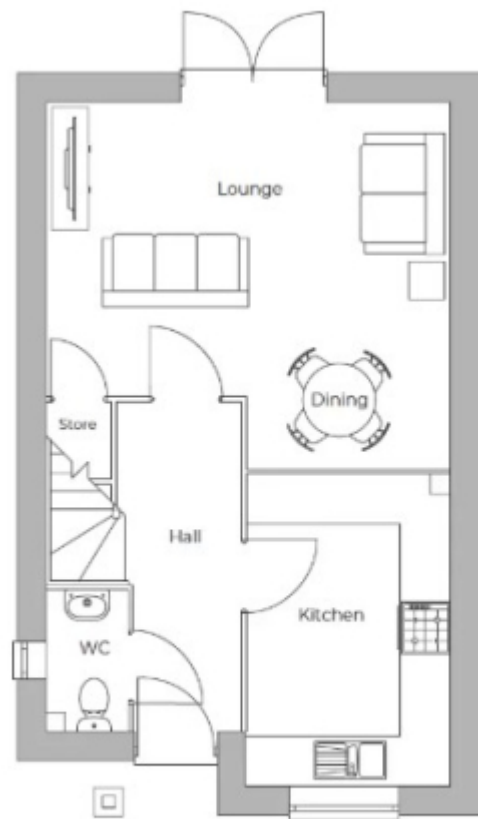

Ground Floor



First Floor

This floorplan is for illustrative purposes only and the location of doors, windows and other items are approximate.

Telephone: 01773 832355

 **DERBYSHIRE  
PROPERTIES**  
= RAINBOW PARTNERS =

[www.derbyshireproperties.com](http://www.derbyshireproperties.com)